

Vineyard Collection



Vineyard Collection

From The Forest
Innovations In Wood Flooring

Preserved for Years to Come



Engineered to Last

Natural hardwood protected with Wearmax® XT ceramic finish and our dent resistant wood fiber CORE 360®

- 2 X's more dent resistant than any other wood floor
- Choose from 8" and 5" widths. Install them separately or together for a random width appearance
- Warranty: Limited Lifetime Residential and 10 year Light Commercial
- Installation options
 - Float
 - Glue
 - Nail
- Hydronic radiant heat approved
- Made in the USA from North American Hardwoods



Engineered Wood Flooring!
Sustain the Earth's vital resources. The right decision for today and tomorrow!

Vineyard Collection



PARTS BAG 59283 & 59284 - From the Forest Vineyard Collection Display

PART	Quantity	Reference
Cam-Lock	19 (1 extra)	A
Capped Bolt	7	B
Double Ended Bolt	3	C
Threaded Bolt	5	D
Wood Dowel	6	E
Hinge	3	F
Hinge Screw	12	G
Trusshead Screw	12	H
Socket Head Cap Screw	2	I
Drywall Screw	2	J
Gate Hook & Eye	1	K
J-Hook	1	L
Scents	1	CC

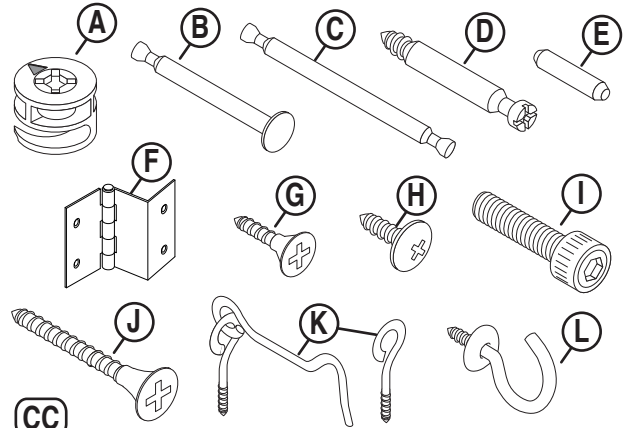

TOOLS REQUIRED: #2 Phillips Screwdriver & Pliers

PARTS LIST

PART	Quantity	Reference
Header	1	M
Header Support	1	N
Post	1	O
Upper Hub-Narrow Slots	1	P
Door Support	1	Q
Rear Panel	2	R
Slot Panel	1	S
Shelf	5	T
Lower Hub-Wide Slots	1	U
Base Panel	1	V
Base	1	W
Door	1	X
Upper Graphic*	1	Y
Door Trim	1	Z
Lower Front Panel	1	AA
Lower Graphic*	1	BB
Display Presentation Kit	1	DD

***Note: French Vineyard Collection Display graphics are different than the ones shown.**

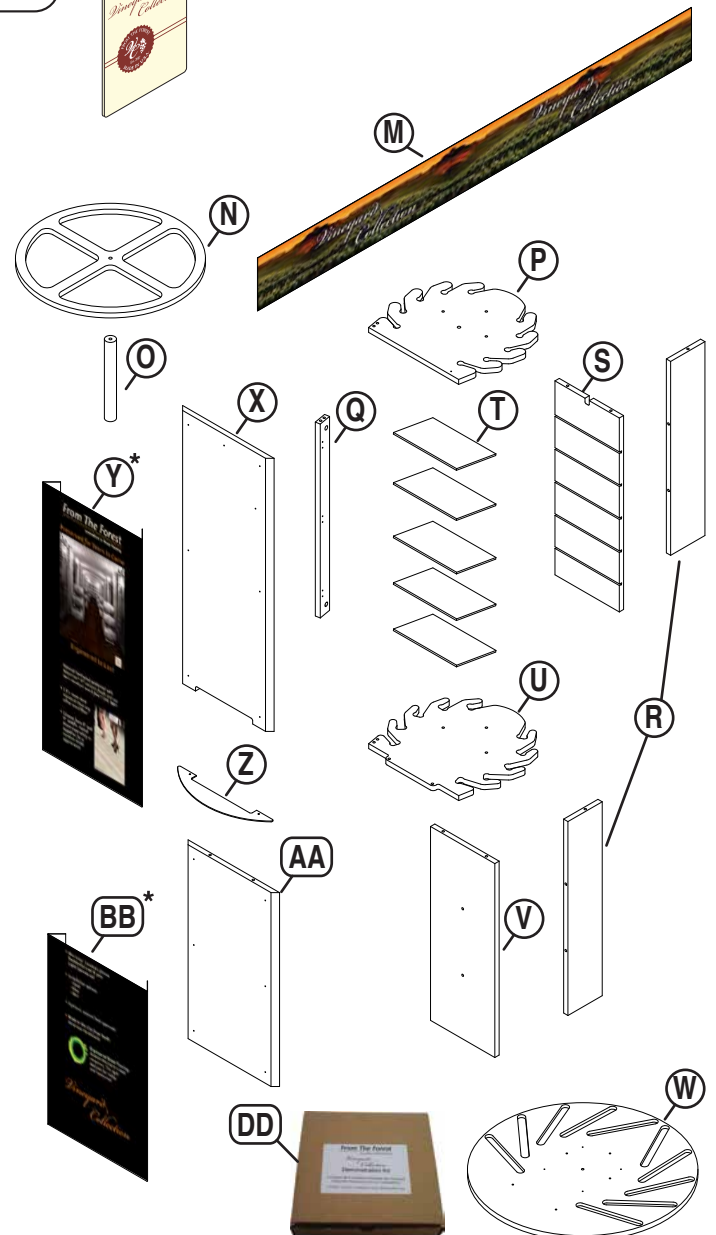

ASSEMBLY

- 1 Screw (5) Threaded Bolts (D) into Base (W).

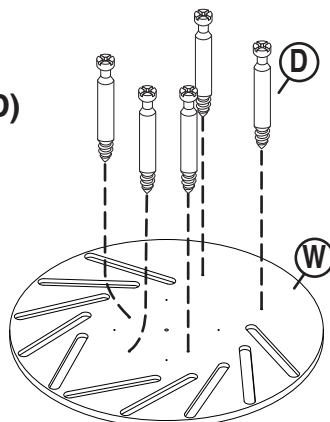

If you have any questions or need replacement parts, please call:
UPC Customer Service
1-800-859-7442

Design & Manufacture

If you have any questions or need replacement parts, please call:
UPC Customer Service
 1-800-859-7442

Design & Manufacture

ASSEMBLY

2 Install (4) **Cam-Locks (A)** into (2) **Rear Panels (R)**.

Install (4) **Cam-Locks (A)** into **Slot Panel (S)**.

Install (4) **Cam-Locks (A)** into **Base Panel (V)**.

Install (2) **Cam-Locks (A)** into **Door Support (Q)**.

Install (4) **Cam-Locks (A)** into **Lower Front Panel (AA)**.

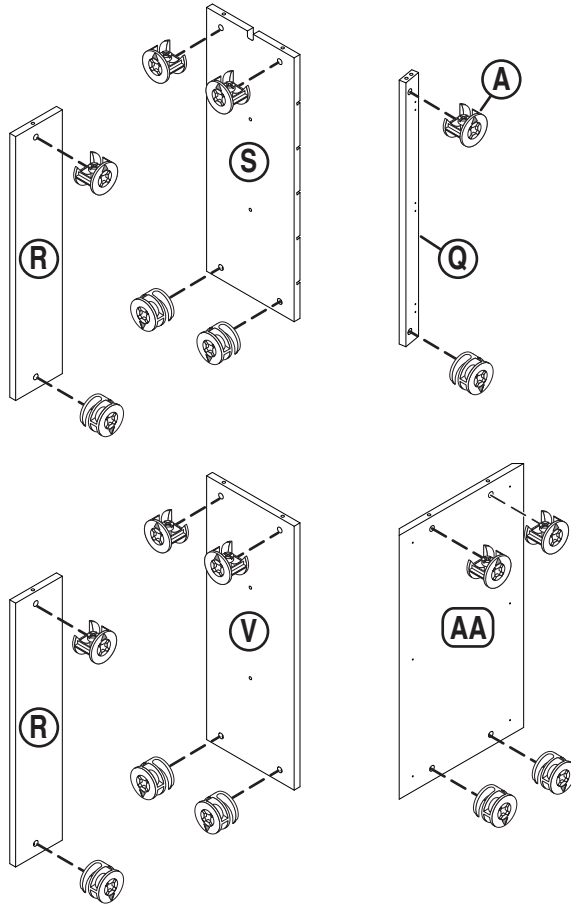

Cam-Lock INSTRUCTIONS

1 Install Cam Lock in hole and point arrow towards edge hole.

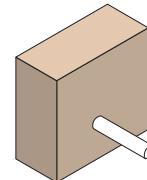
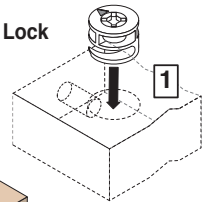

2 Insert Bolt into Cam Edge Hole.

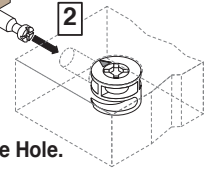

3 Turn Cam-Lock clockwise to Lock Cam over MiniFix.

3 Install (4) **Wood Dowels (E)** into (2) **Rear Panels (R)**. Install (2) **Wood Dowels (E)** into **Door Support (Q)**. Make sure **Dowel** goes in hole away from **Cam-Lock (A)**.

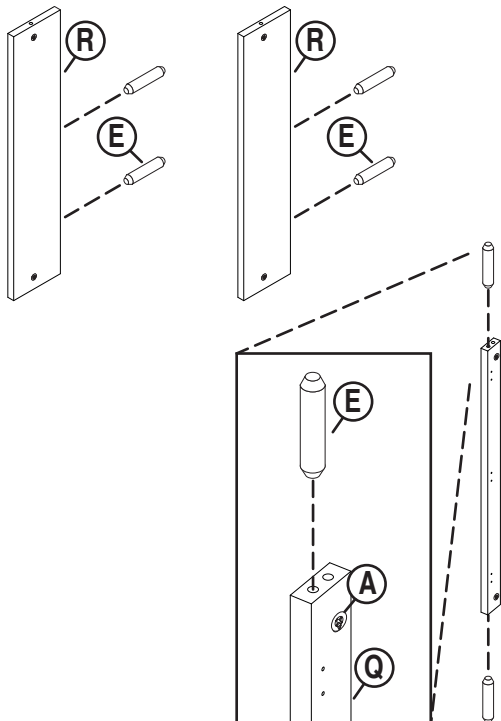

4 Set **Base Panel (V)** onto **Threaded Bolts (D)** in **Base (W)** and hold.

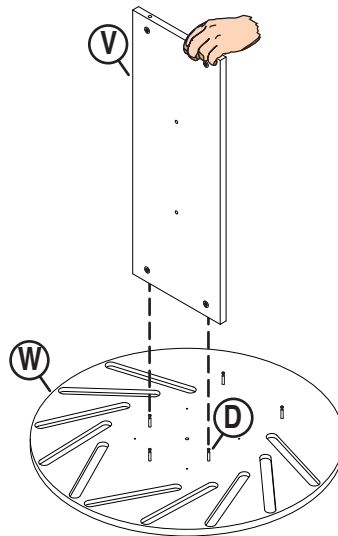

5 While holding **Base Panel (V)** set **Rear Panel (R)** onto Bolt in **Base (W)** and rotate into **Base Panel (V)** aligning **Wood Dowels (E)** into holes. Tighten all bottom (3) **Cam-Locks (A)**.

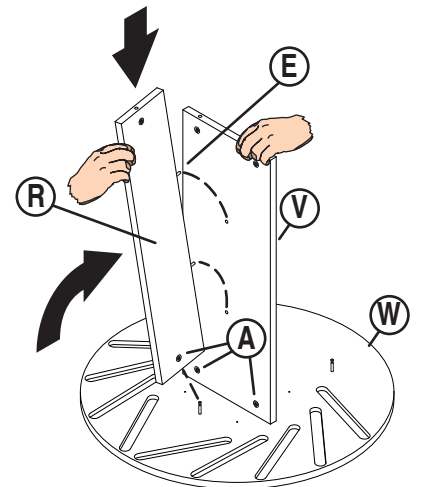

If you have any questions or need replacement parts, please call:
UPC Customer Service
1-800-859-7442

Design & Manufacture

ASSEMBLY

- 6** Fill out **Sample Label** on back of **Door (X)**.

TO ORDER MORE SAMPLES:
CALL: _____
EMAIL: _____

Note:

(Sales Rep to fill in their name or their company's name)

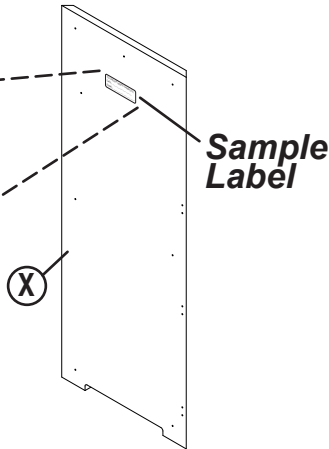

- 7** Attach 1 side of **Upper Graphic (Y)** to **Door (X)** using (3) **Trusshead Screws (H)**. Flex other side around other edge of **Door (X)** and attach using (3) **Trusshead Screws (H)**.

Note:

Door bottom has notch. Make sure bottom of **Graphic** aligns with **Door** bottom.

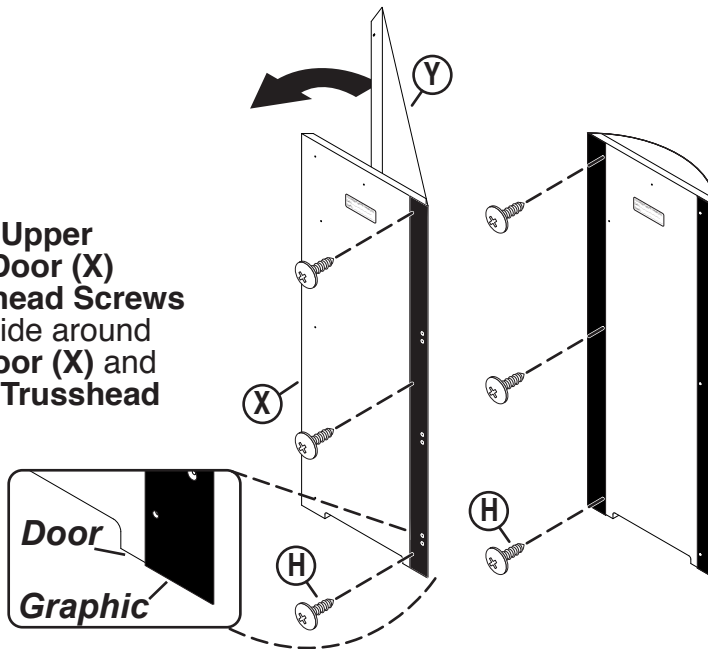

- 8** Attach **Door Trim (Z)** to **Door Assembly** using (2) **Drywall Screws (J)**.

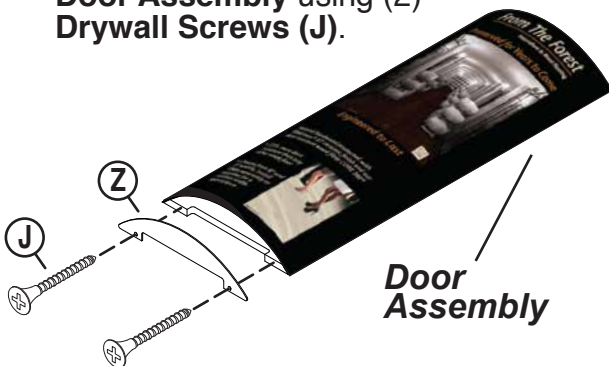

- 9** Attach (1) side of **Lower Graphic (BB)** to **Lower Front Panel (AA)** using (3) **Trusshead Screws (H)**. Flex other side around other edge of **Lower Front Panel (AA)** and attach using (3) **Trusshead Screws (H)**.

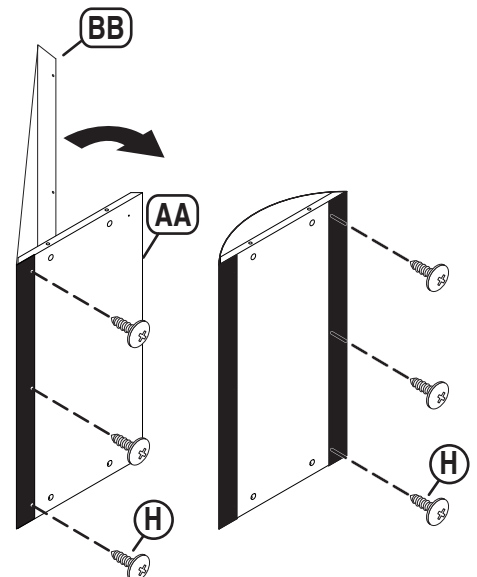

ASSEMBLY

- 10** Attach **Lower Front Panel (AA)** to **Base (W)** following Cam-Lock Instructions.

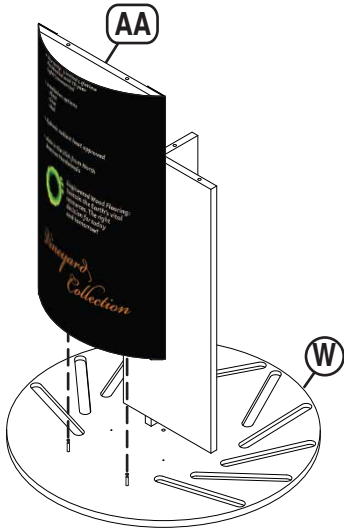

- 11** Insert (2) **Double Ended Bolts (C)** into **Base Panel (V)** and (1) **Double Ended Bolt (C)** into **Rear Panel (R)**. Secure following Cam-Lock Instructions.

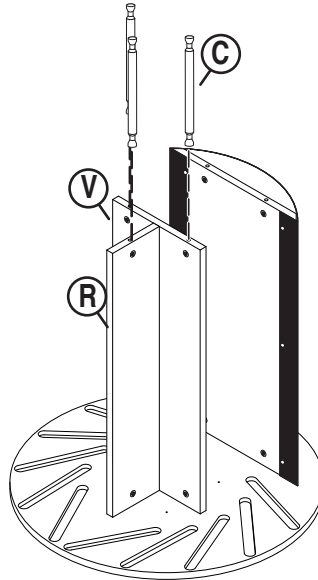

- 12** Slide **Lower Hub-Wide Slots (U)** over **Double Ended Bolts (C)** on panel assembly.

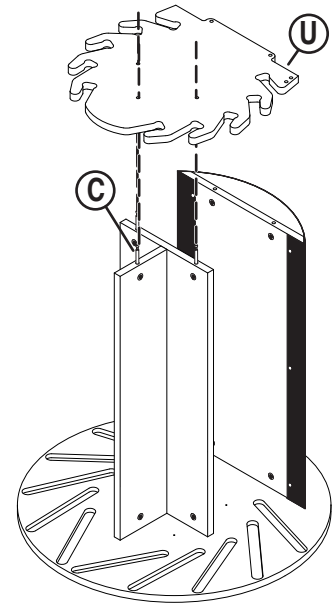

- 13** Secure **Lower Hub-Wide Slots (U)** to **Lower Front Panel (AA)** Using (2) **Capped Bolts (B)** following Cam-Lock Instructions.

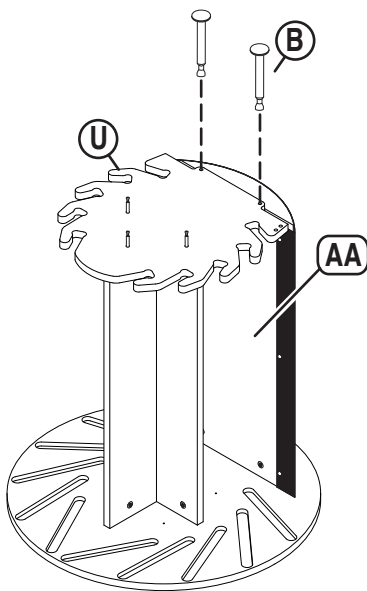

- 14** Set **Slot Panel (S)** onto **Double Ended Bolts (C)** with the **Notch** at the top as shown below and hold.

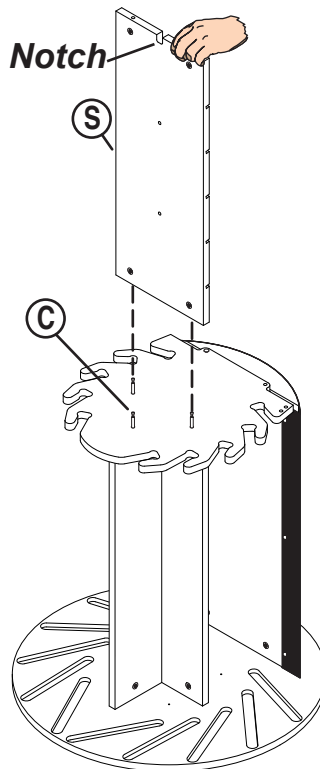

- 15** While holding **Slot Panel (S)** set **Rear Panel (R)** onto **Double Ended Bolt (C)** in **Lower Hub-Wide Slots (U)** and rotate into **Slot Panel (S)** aligning **Wood Dowels (E)** into holes.

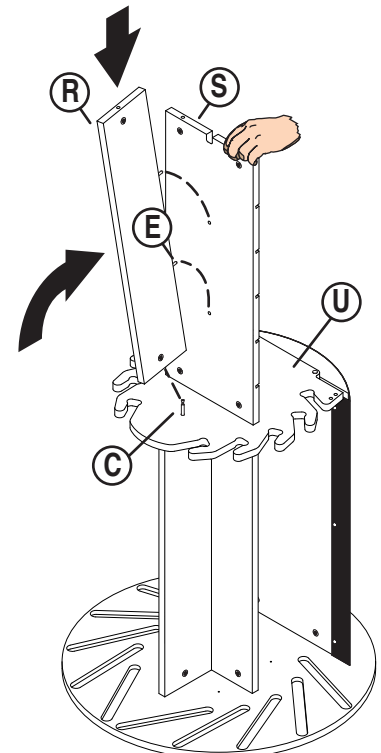

ASSEMBLY

- 16** Insert **Wood Dowel (E)** on **Door Support (Q)** into hole in **Lower Hub-Wide Slots (U)** with cams facing the inside of the display as shown to the right.

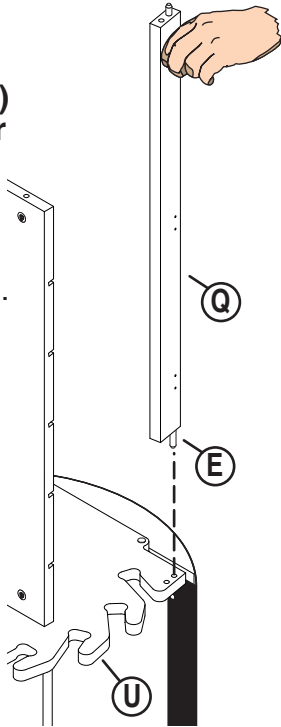

- 17** While holding **Door Support (Q)** secure it to **Lower Hub-Wide Slots (U)** using (1) **Capped Bolt (B)** following Cam-Lock Instructions.

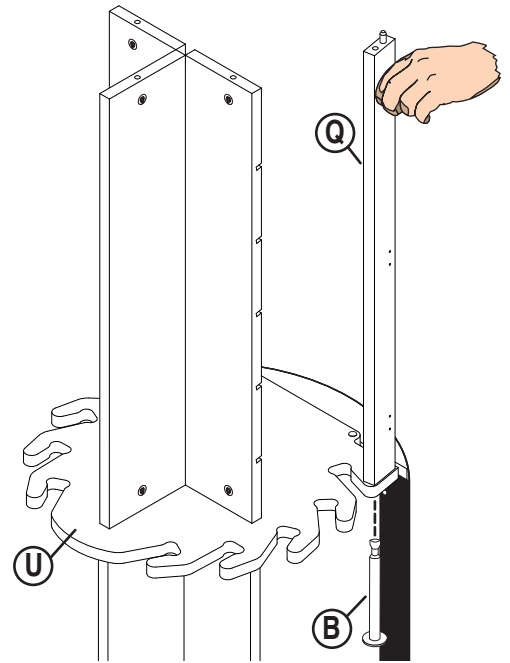

- 18** Install **Gate Hook & Eye (K)** (without hook) to **Upper Hub-Narrow Slots (P)**.

Note:

- (1) Start by hand screwing
- (2) Finish with pliers or by inserting screwdriver through eye and turning as shown below.

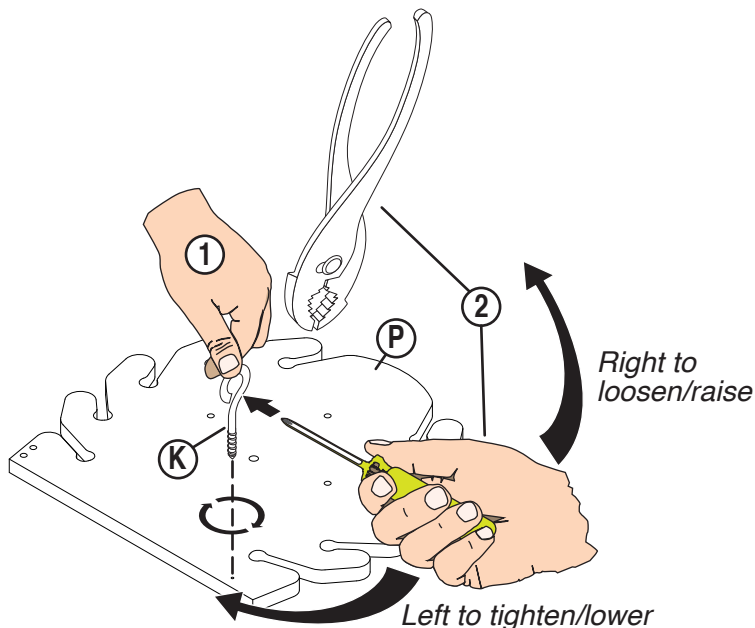

- 19** Align **Upper Hub-Narrow Slots (P)** with **Wood Dowel (E)** on **Door Support (Q)** and lower onto assembly. Attach to display using (4) **Capped Bolts (B)** following Cam-Lock Instructions.

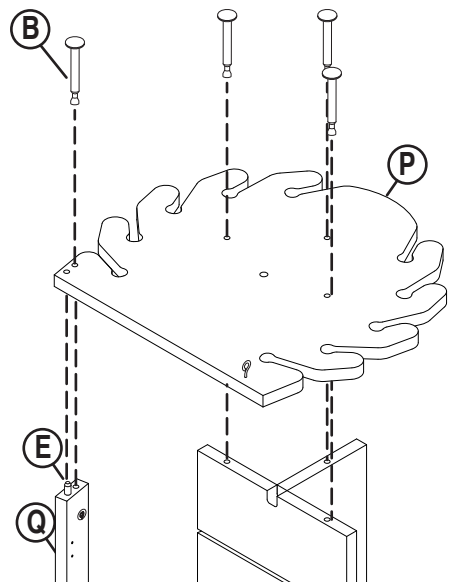

ASSEMBLY

- 20** Attach (3) Hinges (F) to Door Assembly using (6) Hinge Screws (G).

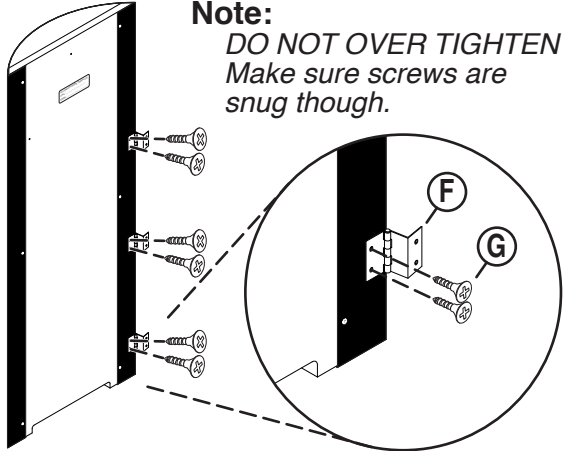

- 21** Install J-Hook (L) and Gate Hook & Eye (K) on Door (X).

Note:

- (1) Start by hand screwing
- (2) Finish with pliers or screwdriver if required.

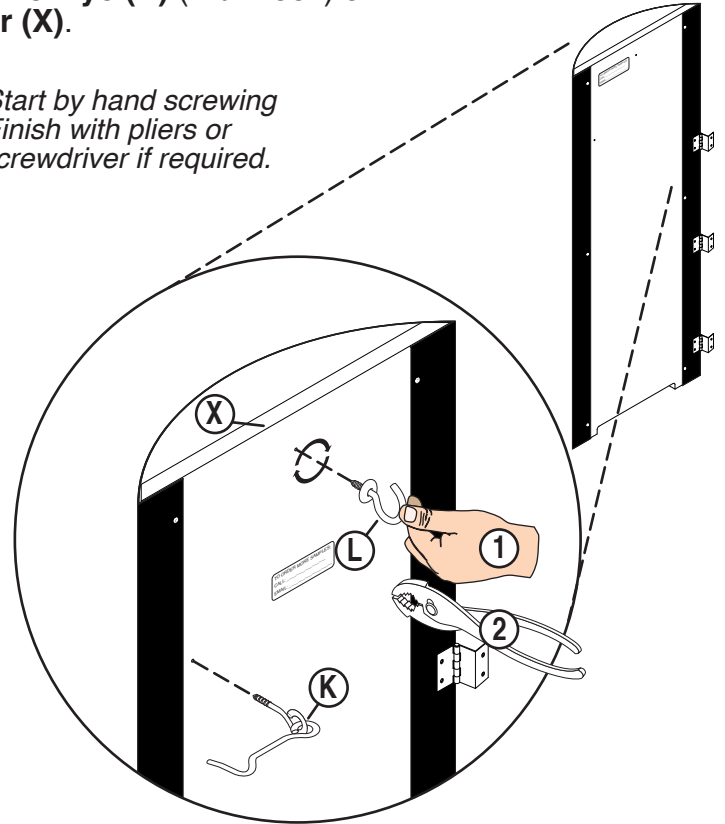

- 22** Attach Door assembly to Door Support (Q) using (6) Hinge Screws (G).

Note:

You will need a second person to hold the Door Assembly while you attach to Door Support (Q)

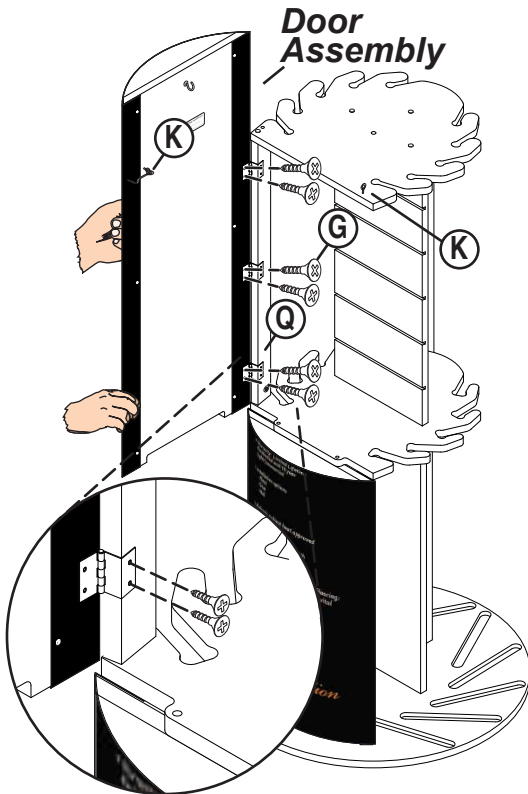

- 23** Test to make sure Gate Hook & Eye (K) will latch if not adjust following Step 18.

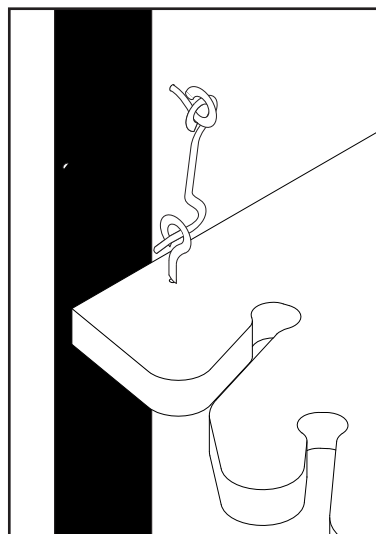

ASSEMBLY

- 24** Alignment of Header (M) with bottom edge of Header Support (N) is critical before pressing Header (M) into position!

Place Header Support (N) on flat surface (table or counter) and remove protective cover from tape strip around Header Support (N).

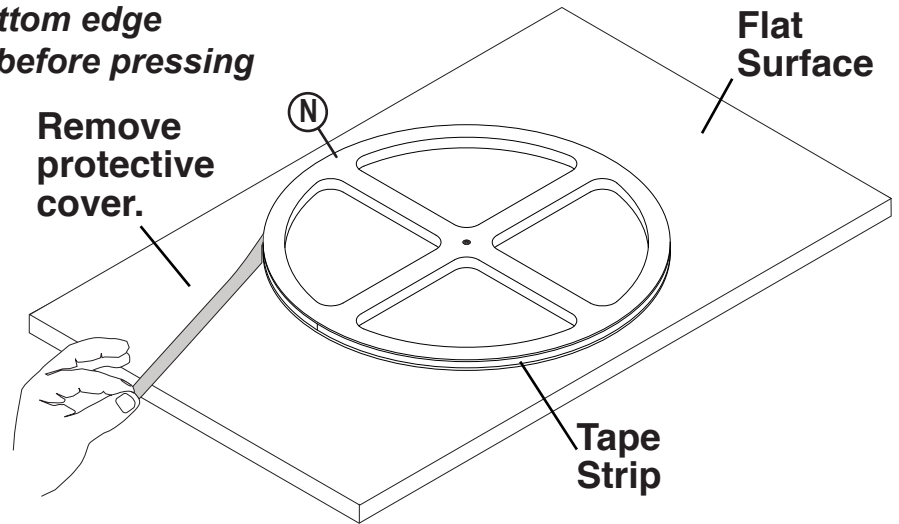

- 25** Set Header (M) on flat surface. Align and attach first the end without tape strip on back of Header (M) carefully with bottom edge of Header Support (N) press securely to attached tape, continue to rotate and press securely, until about three fourths of the way around.

Make sure tape strip on Header (M) is on inside facing Header Support (N).

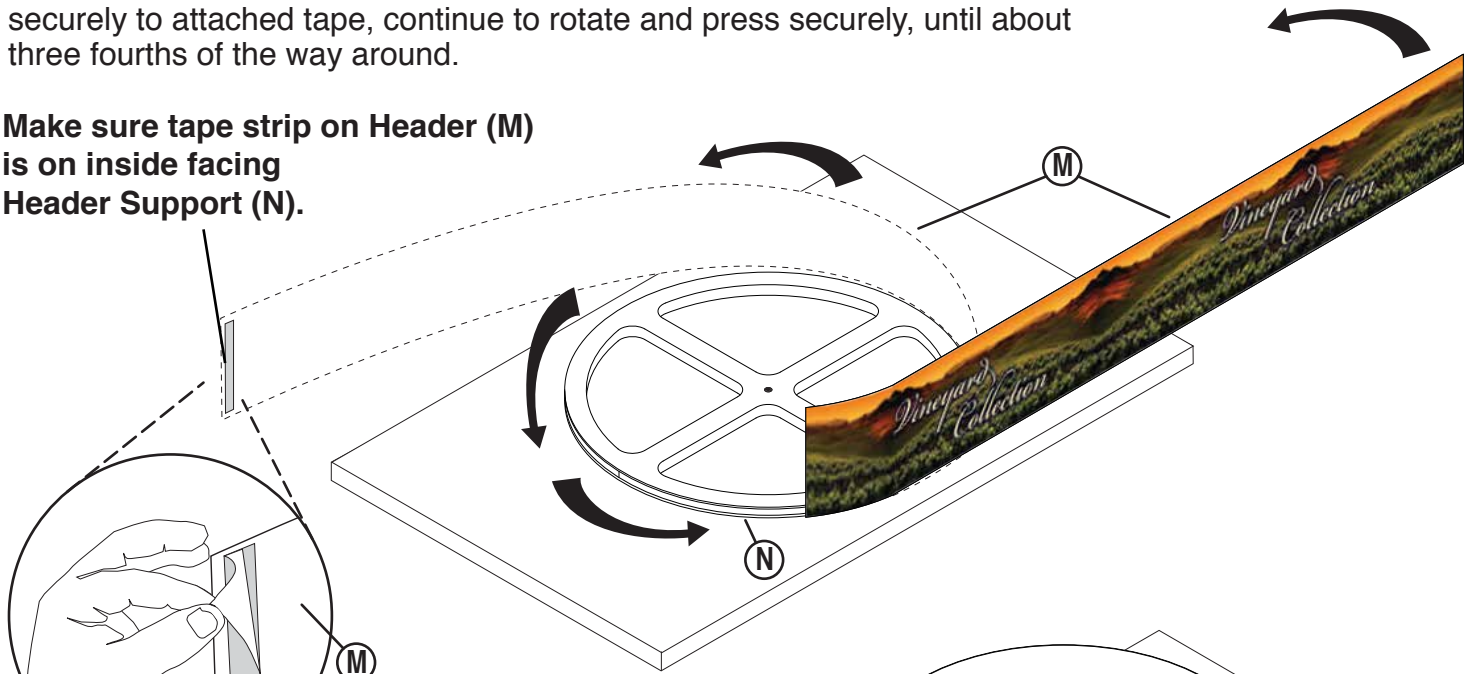

- 26** Remove protective tape strip from Header (M).

- 27** Continue to rotate as you press Header (M) tape strip securely to other end of Header (M) until fully attached as shown to the right.



ASSEMBLY

- 28** Attach **Header Assembly** to **Post (O)** by holding (1) **Socket Head Cap Screw (I)** with fingers and twisting **Post (O)** until snug.

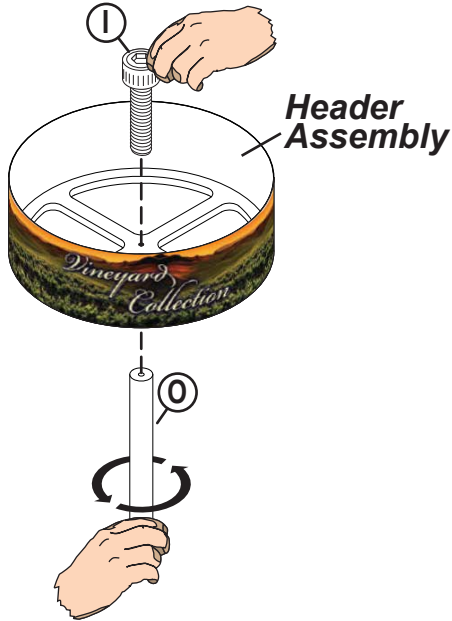

- 29** Attach **Post (O)** on **Header Assembly** to **Upper Hub-Narrow Slots (P)** by holding (1) **Socket Head Cap Screw (I)** with fingers and twisting **Post (O)** until snug.

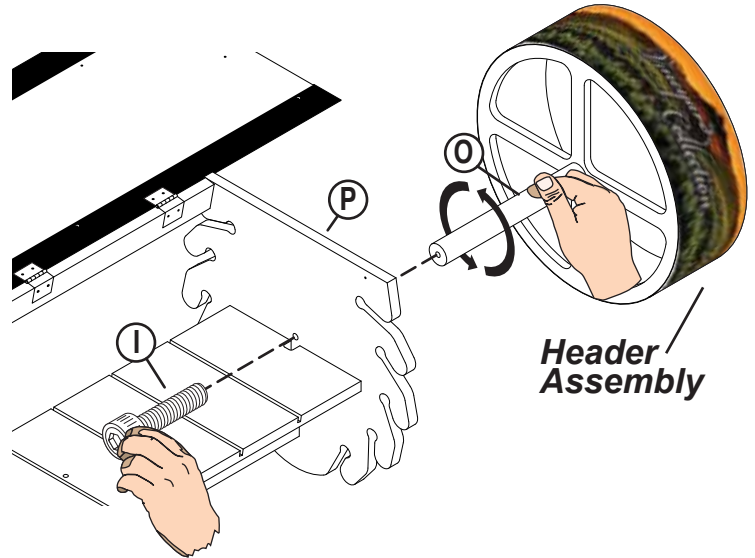

- 30** Insert (5) **Shelves (T)** into **Slot Panel (S)**.

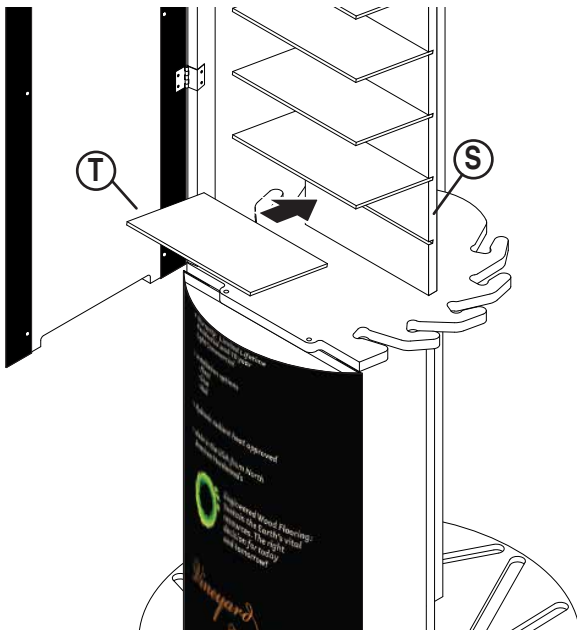

- 31** Hang **Scents (CC)** on **J-Hook (L)**.

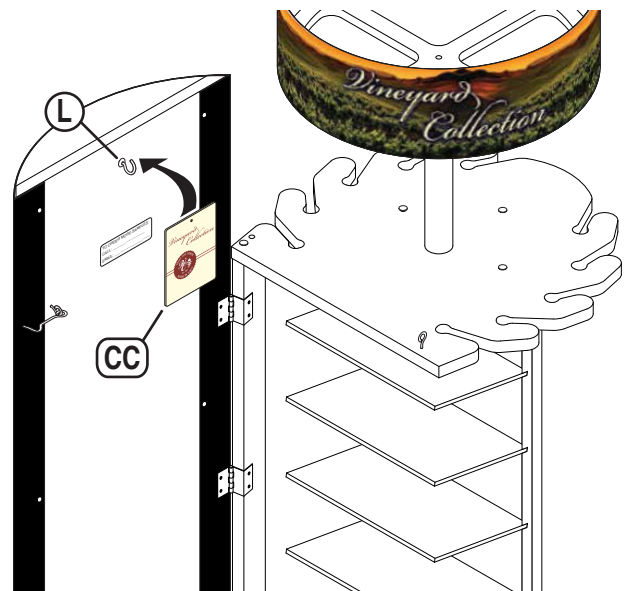

If you have any questions or need replacement parts, please call:
UPC Customer Service
1-800-859-7442

Design & Manufacture

ASSEMBLY

32 Install **Large Flooring Boards** and **Small Flooring Boards** into slots.

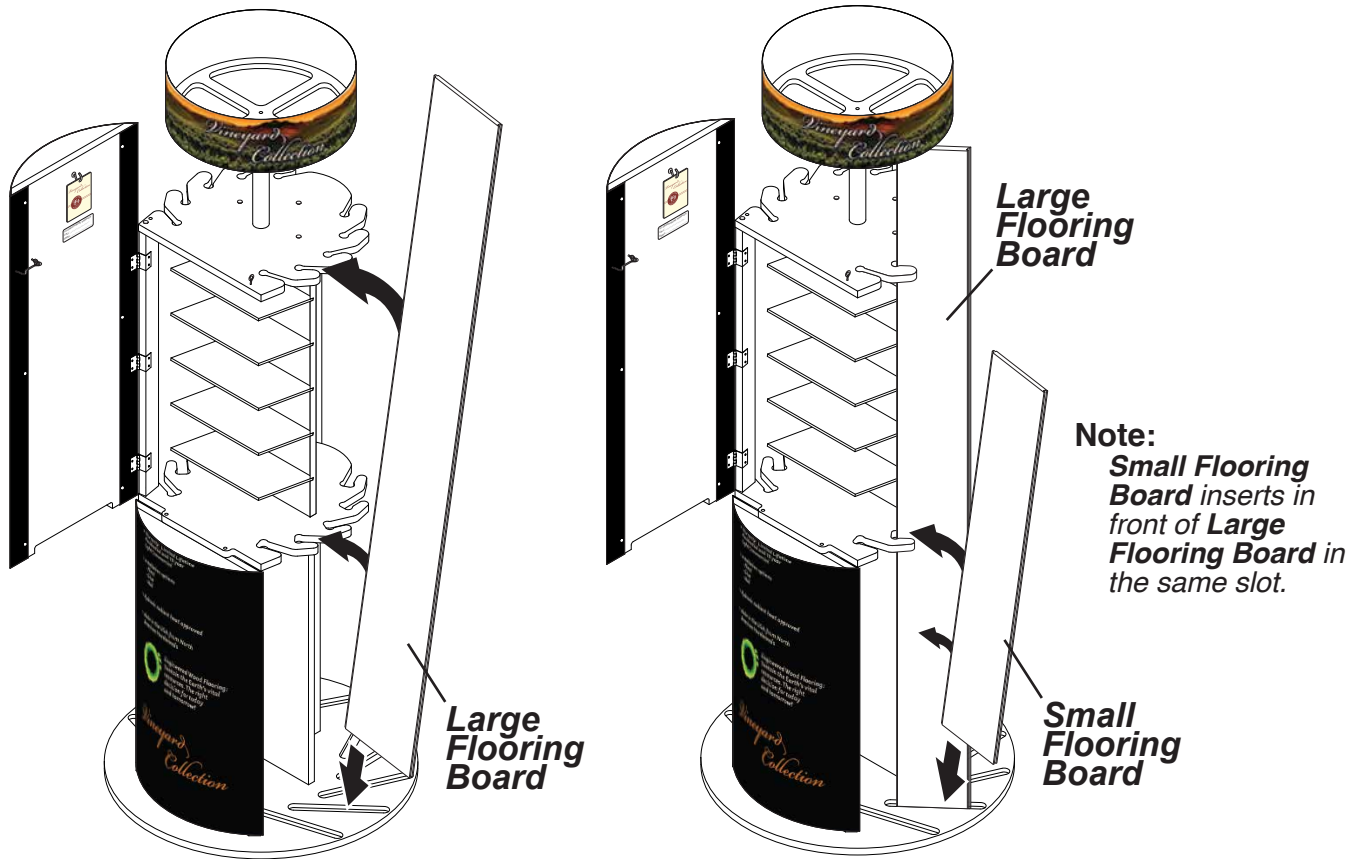

33 Load (20) **Take Home Samples** into storage cabinet area.



34 Place **Display Presentation Kit (DD)** on top of **Upper Hub-Narrow Slots (P)**.

